

1	PG5V
2	PG0V
3	FRAME GROUND
4	BAT (+)
5	BAT (-)
6	DATA (+)
7	DATA (-)
8	-
CON. CASE	FRAME GROUND

NOTES

- ## MOTOR TERMINAL CONNECTION

1	BRAKE
3	PHASE U
4	PHASE V
6	BRAKE
7	PHASE W
FG	FRAME GROUND
CON. CASE	FRAME GROUND

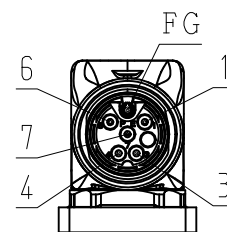

VIEW B

RECEPTACLE SIZE:M17
HOUSING:ST-5EP1N8AA500S
MAKER:PHOENIX CONTACT

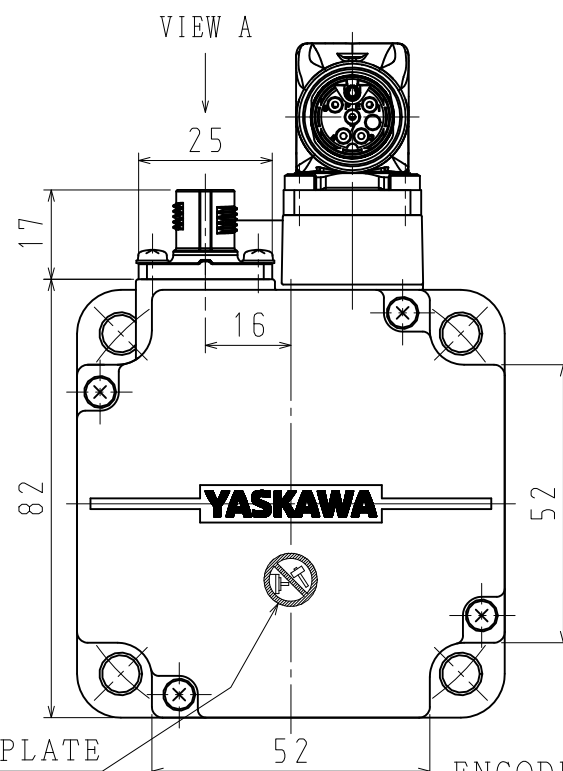
[illegible]

HOLDING BRAKE/ NAME PLATE/ /NAME PLATE
BEARING
 DO NOT USE AS FIXATION OF LOAD

10. DO NOT TOUCH EACH OF CONNECTOR PINS DIRECTLY.
IT CAUSES FAILURE.
11. MOTOR CONNECTOR COULD BE TURNED IN THE RANGE OF ☆
WITHIN 10 TIMES.

ITEM NO. 7 SUPPLIES A KEY.

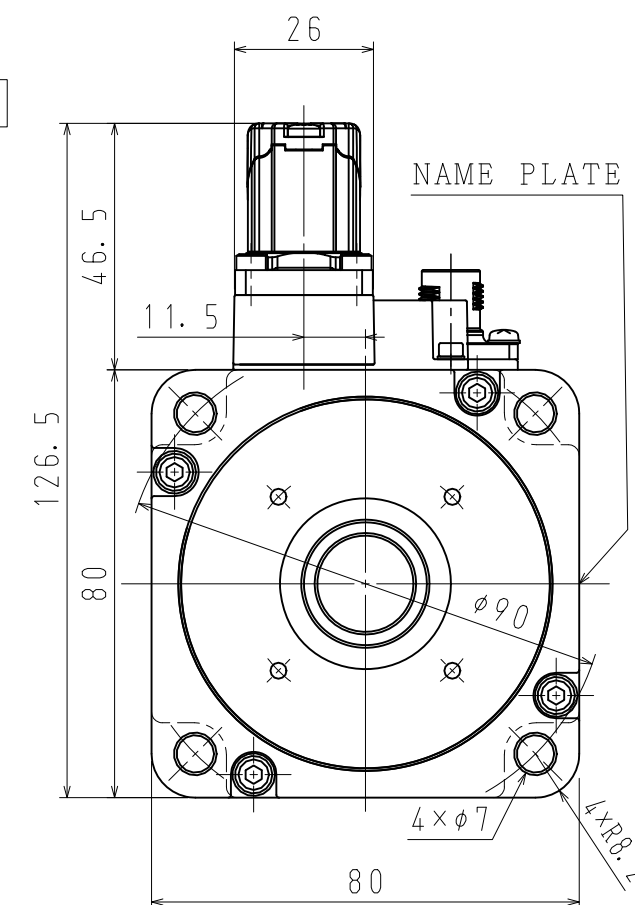

RATED OUTPUT (W)	HOLDING BRAKE SPECIFICATIONS			
	MOMENT OF INERTIA $\text{GD}^2/4 \text{ (kg} \cdot \text{m}^2\text{)}$	HOLDING TORQUE (N·m)	RATED VOLTAGE	CAPACIT (W)
750	1.8×10^{-5}	2.39	DC24V $\pm 10\%$	6.5

ITEM NO.	TYPE	SHAFT TYPE	L (mm)	LL (mm)	LM (mm)	RATED OUTPUT (W)	RATED TORQUE (N · m)	TIME RATING	RATED SPEED (min ⁻¹)	VOLTAGE (V rms)	RATED CURRENT (A rms)	THERMAL CLASS	WEIGHT (kg)	ALLWABLE RADIAL LOAD Fr (N)	ALLWABLE THRUST LOAD Fs (N)
1	SGM7A-08D7F2C	STRAIGHT	193.5	153.5	79	750	2.39	CONT.	3000	400 (3PHASE)	2.2	B	3.0	392	147
2	SGM7A-08D7F6C	KEY+TAP													



DRWN.	S. KAMIJO
CHKD.	T. HIROSE
APRV.	K. AOKI

TITLE	AC SERVOMOTOR Σ -7 SERIES
	SGM7A MODEL 750W

DRWN. DATE	JUN. 06, ' 15
DWG. NO.	900-180-730

REV